



## Handling System for Pot & Pans Pre-wash/Unloading Table with Deep Right Basin

ITEM # \_\_\_\_\_

MODEL # \_\_\_\_\_

NAME # \_\_\_\_\_

SIS # \_\_\_\_\_

AIA # \_\_\_\_\_



865357 (BHPPTB09R)

Prewash table with deep right basin for pass-through Pot and Pan Washer, 900mm

### Short Form Specification

Item No. \_\_\_\_\_

For potwasher. Table top in polished AISI 304 stainless steel, with anti-drip edge and backsplash mm300h. N. 2 square 40x40mm tubular legs on height-adjustable feet. Bowl size mm700x500x250h box strainer with bucket for shut-off valve (non included). Deep basin on right side.

### Main Features

- Supplied knocked-down and easy to assemble.
- Pre-wash tables equipped with splash guard, sink with deep basin and removable stainless steel strainer basket.
- Equipped with plain and grid under shelves, a pre-wash spray unit and a shut off valve.

### Construction

- 304 AISI stainless steel construction throughout.
- To be secured to the dishwasher and fitted with one pair of legs at the other end.
- All surfaces smooth with polished finish.
- Stainless steel square 40x40mm tubular legs.
- Deep anti-drip profiles completely folded with lower edge for safe and easy cleaning.

### Optional Accessories

- Grid undershelf for Pot and Pan Washer table, 900 mm PNC 865365
- Floor fastening kit for 2 square legs PNC 865386
- Undershelf for Pot and Pan Washer table, 900 mm PNC 865387
- Single plastic drain syphon 2" for Sinks PNC 895313

APPROVAL: \_\_\_\_\_



Experience the Excellence  
www.electroluxprofessional.com

**Key Information:**

External dimensions, Width:	
865357 (BHPPTB09R)	900 mm
External dimensions, Depth:	867 mm
External dimensions, Height:	1123 mm
Net weight:	8 kg

Front

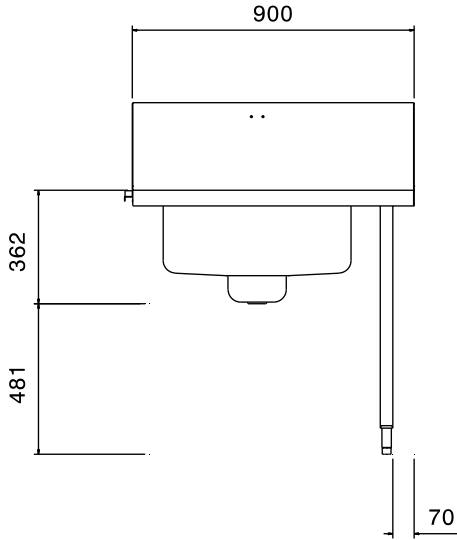

Side

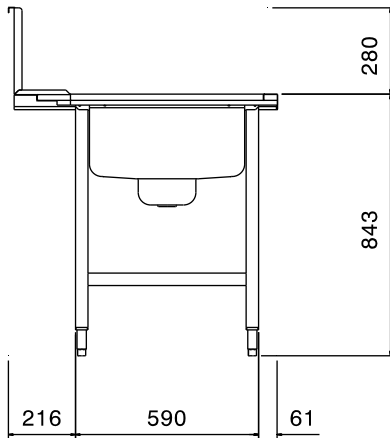

Top

